



Three lobe knobs

elesa[®]

Three-lobe knobs



• Material

Glass-fibre reinforced polyamide based (PA) technopolymer. Resistant to solvents, oils, greases and other chemical agents.

• Colour

Black, matte finish.

• Standard executions

- **VTT-SST**: AISI 304 stainless steel boss, threaded blind hole.
- **VTT-SST-p**: AISI 304 stainless steel threaded stud, chamfered flat end according to UNI 947 : ISO 4753.

Features and applications

The three-lobe shape with large recesses is particularly ergonomic also for smaller knobs, ensuring an effective grip even with work gloves.

The design without rear recesses, generally suitable for reducing thickness, prevents unhealthy residues from depositing, ensuring maximum easy cleaning. Particularly suitable for applications on machines and equipment whose parts must be frequently cleaned by using water jets or steam.



Conversion Table	
1 mm = 0.039 inch	
D	
mm	inch
25	0.98
32	1.26
40	1.57
50	1.97

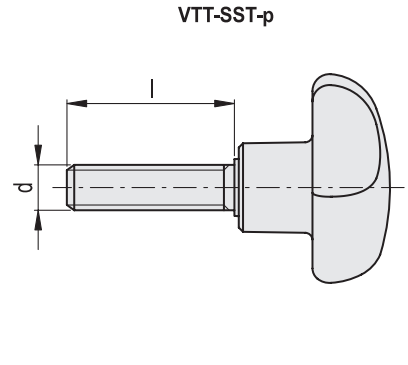
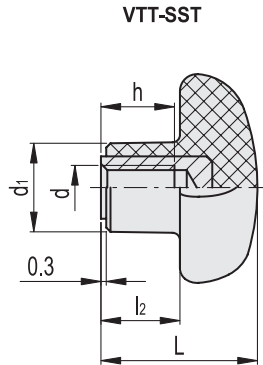
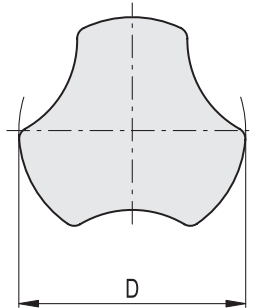

VTT-SST

INOX
Stainless Steel

metric units

Code	Description	D	d _{GH}	L	d ₁	l ₂	h	⚖
167116	VTT.25-SST-M5	25	M5	20	12	10	10	9
167226	VTT.32-SST-M6	32	M6	23	14	11.5	10	19
167346	VTT.40-SST-M8	40	M8	27	16	13.5	13	24
167476	VTT.50-SST-M10	50	M10	30	19	15	17	37

VTT-SST-p

INOX
Stainless Steel

metric units

Code	Description	D	d _{6g}	L	d ₁	l	l ₂	⚖
167161	VTT.25-SST-p-M5x10	25	M5	20	12	10	10	8
167162	VTT.25-SST-p-M5x16	25	M5	20	12	16	10	9
167262	VTT.32-SST-p-M6x16	32	M6	23	14	16	11.5	15
167263	VTT.32-SST-p-M6x20	32	M6	23	14	20	11.5	16
167264	VTT.32-SST-p-M6x30	32	M6	23	14	30	11.5	19
167381	VTT.40-SST-p-M8x20	40	M8	27	16	20	13.5	28
167383	VTT.40-SST-p-M8x30	40	M8	27	16	30	13.5	32
167385	VTT.40-SST-p-M8x40	40	M8	27	16	40	13.5	36
167491	VTT.50-SST-p-M10x20	50	M10	30	19	20	15	47
167493	VTT.50-SST-p-M10x30	50	M10	30	19	30	15	57
167495	VTT.50-SST-p-M10x40	50	M10	30	19	40	15	67

Three-lobe knobs



Material

Glass-fibre reinforced polyamide based (PA) technopolymer. Resistant to solvents, oils, greases and other chemical agents.

Colour

Black, matte finish.

Standard execution

- **VTT-SST**: AISI 304 stainless steel boss, threaded blind hole.
- **VTT-SST-p**: AISI 304 stainless steel threaded stud, chamfered flat end according to UNI 947 : ISO 4753.

Features and applications

The three-lobe shape with large recesses is particularly ergonomic also for smaller knobs, ensuring an effective grip even with work gloves.

The design without rear recesses, generally suitable for reducing thickness, prevents unhealthy residues from depositing, ensuring maximum easy cleaning. Particularly suitable for applications on machines and equipment whose parts must be frequently cleaned by using water jets or steam.

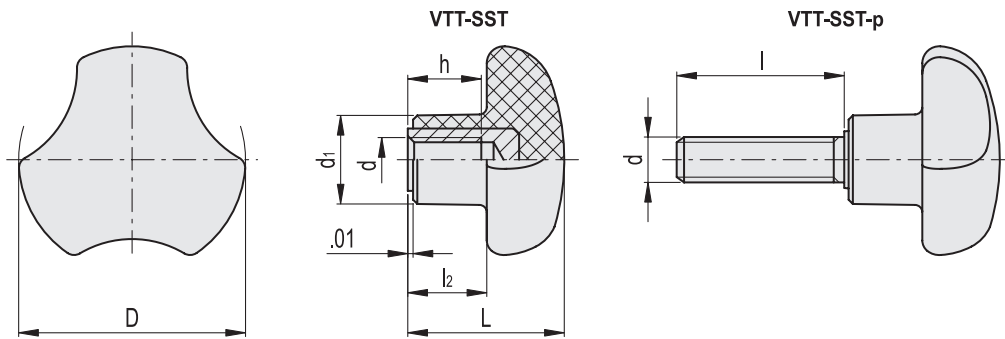

VTT-SST



Code	Description	D	d _{2B}	L	d ₁	l ₂	h	⚖️
9167116	VTT.25-SST-10-32	0.98	10-32	0.79	0.47	0.39	0.39	0.02
9167226	VTT.32-SST-1/4-20	1.26	1/4-20	0.91	0.55	0.45	0.39	0.04
9167346	VTT.40-SST-5/16-18	1.57	5/16-18	1.06	0.63	0.53	0.51	0.05
9167476	VTT.50-SST-3/8-16	1.97	3/8-16	1.18	0.75	0.59	0.67	0.08

VTT-SST-p



Code	Description	D	d _{2A}	L	d ₁	l	l ₂	⚖️
9167161	VTT.25-SST-p-10-32x1/2	0.98	10-32	0.79	0.47	0.500	0.39	0.02
9167162	VTT.25-SST-p-10-32x3/4	0.98	10-32	0.79	0.47	0.750	0.39	0.02
9167262	VTT.32-SST-p-1/4-20x1/2	1.26	1/4-20	0.91	0.55	0.500	0.45	0.03
9167263	VTT.32-SST-p-1/4-20x3/4	1.26	1/4-20	0.91	0.55	0.750	0.45	0.04
9167264	VTT.32-SST-p-1/4-20x1	1.26	1/4-20	0.91	0.55	1.000	0.45	0.04
9167381	VTT.40-SST-p-5/16-18x3/4	1.57	5/16-18	1.06	0.63	0.750	0.53	0.06
9167383	VTT.40-SST-p-5/16-18x1	1.57	5/16-18	1.06	0.63	1.000	0.53	0.07
9167385	VTT.40-SST-p-5/16-18x1¼	1.57	5/16-18	1.06	0.63	1.250	0.53	0.08
9167387	VTT.40-SST-p-5/16-18x1½	1.57	5/16-18	1.06	0.63	1.500	0.53	0.09
9167491	VTT.50-SST-p-3/8-16x3/4	1.97	3/8-16	1.18	0.75	0.750	0.59	0.10
9167493	VTT.50-SST-p-3/8-16x1	1.97	3/8-16	1.18	0.75	1.000	0.59	0.13
9167495	VTT.50-SST-p-3/8-16x1¼	1.97	3/8-16	1.18	0.75	1.250	0.59	0.15
9167497	VTT.50-SST-p-3/8-16x1½	1.97	3/8-16	1.18	0.75	1.500	0.59	0.17

VTT

Three lobe knobs



Ergonomic Design

Three ample lobes to offer a safe and effective grip to the operator even with smaller diameters when wearing gloves too.



Easy cleaning

The absence of recesses prevent unhealthy residues or dust from depositing ensuring maximum cleaning.



Corrosion resistance

AISI 304 stainless steel inserts are particularly suitable for applications which require frequent cleaning operations with water jets.