



Spoked handwheels  
with solid section

**elesa<sup>®</sup>**

# VRTP-P-SST

ELESA Original design

**INOX**  
Stainless Steel

**INCH**

## Spoked handwheels with solid section

PP-FDA

PA-FDA

+175°F  
+30°F

RoHS

### • Material

High-resilience polypropylene based (PP) technopolymer.  
Certified in compliance with FDA (U.S. Food and Drug Administration).

### • Colour

Black, matte finish.

### • Boss-cap

AISI 304 stainless steel self-adhesive front plate (adhesive certified in compliance with FDA U.S. Food and Drug Administration).

### • Standard execution

AISI 304 stainless steel boss, standard reamed hole.  
See table for maximum permissible boring diameters  $d'$  and  $d''$ .

- **VRTP-P+I-SST**: polyamide based (PA) technopolymer revolving handle type I.621, certified in compliance with FDA, black colour, matte finish. AISI 304 stainless steel pin.

- **VRTP-P+IR-SST**: polyamide based (PA) technopolymer fold-away handle type IR.620, certified in compliance with FDA, black colour, matte finish. AISI 304 stainless steel pin, bushing and internal components, AISI 316L stainless steel support.

### Special executions on request

Boss with hole and keyway in compliance with ANSI B17.1-1967 tolerance (see Catalogue 062 Technical data page A22).

To order the handwheel with keyway complete code and description with the index -K (i.e. 979111-R-K VRTP80-P+I-SST-5/16-K).

### Accessories on request

Axial retaining washer type GN 184.5 (see Catalogue 062 page 594).

### Features and applications

The solid rim of the handwheel allows the maximum cleaning thanks to the absence of rear recesses. For this reason, with the technopolymer polypropylene based and the metal components in AISI 304 stainless steel, this version of VRTP handwheel is designed for applications in food, pharmaceutical and medical fields.

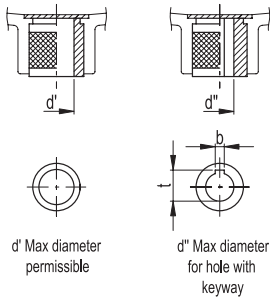

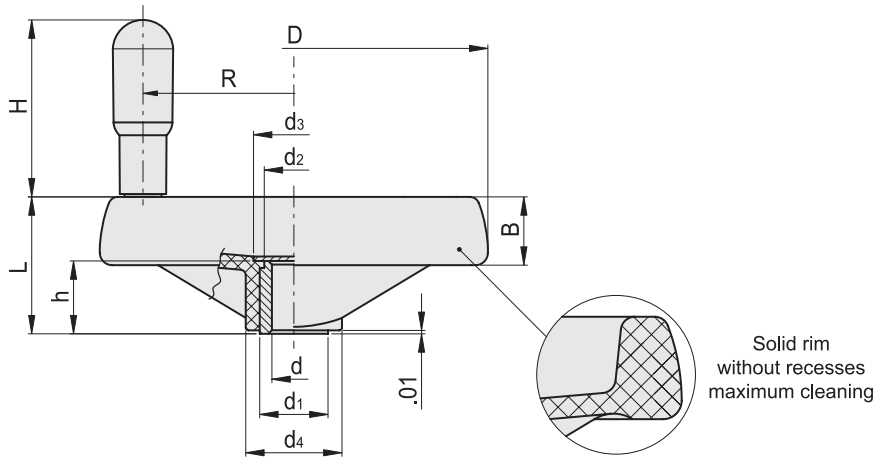

**VRTP-P+I-SST**

INOX Stainless Steel **american units**

Elesa Standards		Main dimensions							Bore		Handle		Max permissible holes				C #	L #	△△
Code	Description	D	L	B	d1	d2	d3	d4	d	h	H	R	d'	d"	t	b	[ft-lb]	[ft-lb]	lbs
979111-R	VRTP.80-P+I-SST-5/16	3.15	1.38	0.71	0.71	0.63	0.81	0.98	0.312	0.67	1.77	1.14	0.500	0.375	0.421	3/32	24	4	0.229
979161-R	VRTP.100-P+I-SST-3/8	3.9	1.46	0.79	0.71	0.63	0.81	1	0.375	0.67	2.36	1.46	0.500	0.375	0.421	3/32	40	5	0.319
979211-R	VRTP.125-P+I-SST-3/8	4.92	1.73	0.87	0.87	0.79	1.02	1.22	0.375	0.87	2.56	1.89	0.625	0.500	0.560	1/8	69	7	0.54
979261-R	VRTP.160-P+I-SST-1/2	6.3	2.01	0.98	1.02	0.94	1.26	1.57	0.500	1.06	2.87	2.56	0.750	0.625	0.709	3/16	136	11	0.784
979311-R	VRTP.200-P+I-SST-5/8	7.87	2.4	1.1	1.18	1.1	1.42	1.97	0.625	1.34	3.15	3.31	1.000	0.750	0.837	3/16	221	18	1.216

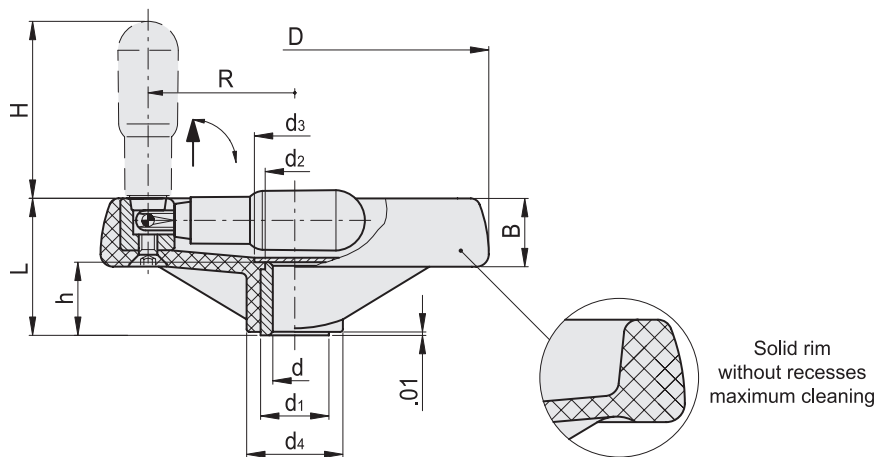

**VRTP-P+IR-SST**

INOX Stainless Steel **american units**

Elesa Standards		Main dimensions							Bore		Handle		Max permissible holes				C #	L #	△△
Code	Description	D	L	B	d1	d2	d3	d4	d	h	H	R	d'	d"	t	b	[ft-lb]	[ft-lb]	lbs
979121-R	VRTP.80-P+IR-SST-5/16	3.15	1.38	0.71	0.71	0.63	0.81	0.98	0.312	0.67	1.77	1.14	0.500	0.375	0.421	3/32	24	4	0.225
979171-R	VRTP.100-P+IR-SST-3/8	3.9	1.46	0.79	0.71	0.63	0.81	1	0.375	0.67	2.36	1.46	0.500	0.375	0.421	3/32	40	5	0.359
979221-R	VRTP.125-P+IR-SST-3/8	4.92	1.73	0.87	0.87	0.79	1.02	1.22	0.375	0.87	2.56	1.89	0.625	0.500	0.560	1/8	69	7	0.507
979271-R	VRTP.160-P+IR-SST-1/2	6.3	2.01	0.98	1.02	0.94	1.26	1.57	0.500	1.06	2.87	2.56	0.750	0.625	0.709	3/16	136	11	0.855
979321-R	VRTP.200-P+IR-SST-5/8	7.87	2.4	1.1	1.18	1.1	1.42	1.97	0.625	1.34	3.15	3.31	1.000	0.750	0.837	3/16	221	18	1.306

# See Catalog 062 Technical Data page A3 for maximum applicable torque (C) and impact strength (L).

Models all rights reserved in accordance with the law. Always mention the source when reproducing our drawings.

# Spoked handwheels with solid section

For applications in food, chemical, pharmaceutical and medical fields in compliance with specific hygienic rules.



## **Material suitable for food contact**

Technopolymer handwheel and handle. Certified in compliance with FDA (U.S. Food and Drug Administration).

## **Corrosion resistance**

1. AISI 304 stainless steel handwheel central boss
2. AISI 304 stainless steel revolving handle pin
3. AISI 304 stainless steel pin, bushing and internal components, AISI 316L stainless steel support

## **Easy cleaning**

4. Solid rim
5. Hub without recesses

