

Conduit System Introduction

Electrical Conduit provides protection to enclosed single or multi-conductors from impact, moisture, and chemical vapors. Varying quantities, sizes, and types of conductors can be pulled into a Conduit, which simplifies design and construction compared to multiple runs of cables or the expense of customized composite cables. Conduit Systems can be made waterproof.

Cable connections between fixed and moving parts are weak spots in machine & system installations. When cables are bent, individual tensioned conductors have no room for flexing. They are subjected to high and variable tension forces, particularly multi-conductor cables. To prevent conductor breakages, the use of Conduit tubing is recommended.

Advantages:

- Individual conductors are given sufficient flexibility. This prevents tension stress.
- Connections provide security against penetration of fluids



Operating Temperatures

Push-In Fittings	- 20°C to 80°C (- 4°F to 176°F)
Turn-to-Seal Fittings	- 40°C to 110°C (- 40°F to 230°F)
Snapcllic DUO Nylon	- 40°C to 100°C (- 40°F to 212°F)
Snapcllic DUO Brass	- 40°C to 100°C (- 40°F to 212°F)
Double-Seal Fittings	- 40°C to 110°C (- 40°F to 230°F)
Flange/Bulkhead Fittings	- 20°C to 80°C (- 4°F to 176°F)
Standard Conduit	- 40°C to 110°C (- 40°F to 230°F)
Super-Flex Conduit	- 50°C to 160°C (- 58°F to 320°F)



Conduit System Corrugated Conduit (Standard & Super Flex)

RoHS

This **STANDARD** Corrugated Conduit is made of flame retardant Nylon. The Conduit is suitable for static and moderate dynamic installations.

The **SUPER-FLEX** Conduit is made of a special plastic blend. Due to its higher flexibility, it is an ideal solution for drag chain and robotics applications. Sizes 8 & 14 are not available in this material.



Corrugated Conduit

Part Numbers		Nominal Conduit Size	Roll Length (feet)	Dimensions Inner Dia. (A) x Outer Dia. (B) Inches (mm)	Fits Turn-to-Seal Fittings ST & ET
Standard Modified Polyamide PA 6	SuperFlex Thermoplastic Elastomer				
SM-0811-BK	-	8	164	.33 x .44 (8.5 x 11.2)	PG 7, 1/4" NPT
SM-1013-BK	SM-1013-HY	10	164	.39 x .51 (10 x 13)	PG 7, 1/4" NPT, PG 9
SM-1216-BK	SM-1216-HY	12	164	.47 x .61 (12 x 15.5)	PG 11, 3/8" NPT
SM-1419-BK	-	14	164	.55 x .73 (14 x 18.5)	PG 13
SM-1721-BK	SM-1721-HY	17	164	.65 x .83 (16.5 x 21)	PG 16, 1/2" NPT
SM-2328-BK	SM-2328-HY	23	164	.89 x 1.12 (22.5 x 28.5)	PG 21, 3/4" NPT
SM-2934-BK	SM-2934-HY	29	82	1.12 x 1.36 (28.5 x 34.5)	PG 29, 1" NPT
SM-3642-BK	SM-3642-HY	37	82	1.42 x 1.65 (36 x 42)	PG 36, 1-1/4" NPT
SM-4854-BK	SM-4854-HY	50	82	1.87 x 2.13 (47.5 x 54)	PG 48, 2" NPT



Conduit System Snap-In Mounting Brackets

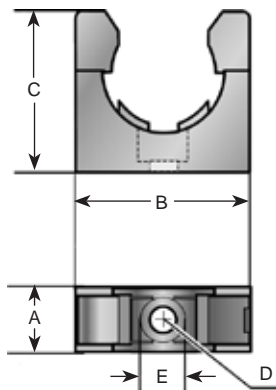

Hold conduit securely in place.

Material: Black Nylon 6/6

Mounting Brackets

Part Numbers	Fits Nominal Conduit Size	Dimensions				
		A Width	B Length	C Height	D Mounting Hole ϕ	E Mounting Hole Recess ϕ
MB-09-BK	10	.47 (12)	1.18 (30)	.91 (23)	.20 (5)	.35 (9)
MB-11-BK	12	.47 (12)	1.18 (30)	.91 (23)	.20 (5)	.39 (10)
MB-16-BK	17	.59 (15)	1.38 (35)	1.18 (30)	.24 (6)	.47 (12)
MB-21-BK	23	.63 (16)	1.65 (42)	1.50 (38)	.26 (6.5)	.47 (12)
MB-29-BK	29	.63 (16)	2.01 (51)	1.93 (49)	.26 (6.5)	.47 (12)
MB-36-BK	37	.71 (18)	2.40 (61)	2.01 (51)	.26 (6.5)	.47 (12)
MB-48-BK	50	.75 (19)	2.91 (74)	2.52 (64)	.26 (6.5)	.47 (12)

- Quick assembly thanks to single-hole fixing
- Simply snap in conduits

Push-In Conduit Fittings

Part Numbers		Thread Type & Size	Fits Nominal Conduit Size	Straight Fittings - Dimensions in Inches (mm)				Elbow Fitting - Dimensions in Inches (mm)						
Straight Fitting	Elbow Fitting			A	B	C	D	A	E	F	G	H		
		See page 49 for thread specs		Clearance Hole + .01" (+.25 mm)	Thread Length	Body Length	Wrench Flat	Clearance Hole	Thread Length	Body Height	Body Length	Wrench Flat		
SM09AA-BK	EM09AA-BK			PG 9	10	.60 (15.2)	.31 (8)	.91 (23)	.67 (17)	.60 (15.2)	.31 (8)	1.69 (43)	.91 (23)	.75 (19)
SM11AA-BK	EM11AA-BK			PG 11	12	.73 (18.5)	.31 (8)	.98 (25)	.83 (21)	.73 (18.5)	.31 (8)	1.89 (48)	1.06 (27)	.87 (22)
SM13AA-BK	EM13AA-BK			PG 13	14	.80 (20.3)	.35 (9)	1.10 (28)	.94 (24)	.80 (20.3)	.35 (9)	2.04 (52)	1.20 (30.5)	.94 (24)
SM16AA-BK	EM16AA-BK			PG 16	17	.88 (22.3)	.39 (10)	1.14 (29)	1.06 (27)	.88 (22.3)	.39 (10)	2.20 (56)	1.28 (32.5)	1.06 (27)
SM21AA-BK	EM21AA-BK			PG 21	23	1.12 (28.4)	.43 (11)	1.26 (32)	1.38 (35)	1.12 (28.4)	.43 (11)	2.76 (70)	1.57 (40)	1.30 (33)
SM29AA-BK	EM29AA-BK			PG 29	29	1.47 (37.3)	.43 (11)	1.38 (35)	1.65 (42)	1.47 (37.3)	.43 (11)	3.27 (83)	2.03 (51.5)	1.65 (42)
SM36AA-BK	-			PG 36	37	1.85 (47)	.51 (13)	1.61 (41)	1.97 (50)	-	-	-	-	-
SM48AA-BK	-			PG 48	50	2.34 (59.4)	.55 (14)	1.81 (46)	2.52 (64)	-	-	-	-	-
SM09NA-BK	EM09NA-BK			3/8" NPT	10	.68 (17.2)	.60 (15)	.91 (23)	.67 (17)	.68 (17.2)	.60 (15)	1.69 (43)	.91 (23)	.75 (19)
SM16NA-BK	EM16NA-BK	1/2" NPT	17	.83 (21.1)	.51 (13)	1.14 (29)	1.06 (27)	.83 (21.1)	.51 (13)	2.20 (56)	1.28 (32.5)	1.06 (27)		
SM21NA-BK	EM21NA-BK	3/4" NPT	23	1.05 (26.7)	.51 (13)	1.26 (32)	1.38 (35)	1.05 (26.7)	.51 (13)	2.76 (70)	1.57 (40)	1.30 (33)		
SM29NA-BK	EM29NA-BK	1" NPT	29	1.35 (34.3)	.59 (15)	1.38 (35)	1.65 (42)	1.35 (34.3)	.59 (15)	3.27 (83)	2.03 (51.5)	1.65 (42)		
SM16MA-BK	EM16MA-BK	M16 x 1.5	10	.63 (16)	.31 (8)	.91 (23)	.67 (17)	.63 (16)	.31 (8)	1.69 (43)	.91 (23)	.75 (19)		
SM20MA-BK	EM20MA-BK	M20 x 1.5	14	.79 (20)	.35 (9)	1.10 (28)	.94 (24)	.79 (20)	.35 (9)	2.04 (52)	1.20 (30.5)	.94 (24)		
SM25MA-BK	EM25MA-BK	M25 x 1.5	23	.98 (25)	.43 (11)	1.26 (32)	1.38 (35)	.98 (25)	.43 (11)	2.76 (70)	1.57 (40)	1.30 (33)		
SM32MA-BK	EM32MA-BK	M32 x 1.5	29	1.26 (32)	.43 (11)	1.38 (35)	1.65 (42)	1.26 (32)	.43 (11)	3.27 (83)	2.03 (51.5)	1.65 (42)		



SM - Straight

The fastest and most labor saving method to connect flexible Nylon Conduit to a Push-in Fitting. The Nylon Conduit is inserted into the Fitting until the hook snaps over the ridge of the Corrugated Tubing. The Conduit can be mounted rigid for liquid tight (NEMA 4x) or turnable for non-liquid tight (NEMA 2).

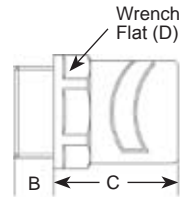

EM - 90° Snap Elbows

Combines the unique 90° Snap Elbow and Straight Push-in Fitting for easy installation of wires into an Elbow Fitting. The "Straight" Elbow is snapped together after the wires have been installed, resulting in a liquid tight 90° Elbow.

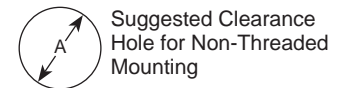
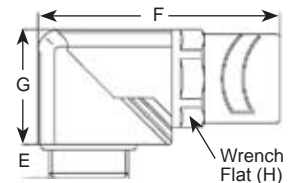

Optional Locking Nuts, O-Rings & Other Accessories starting at page 28.

SM & EM Fittings feature a Locking Ridge to hold Conduit Tubing in place.

They also have an O-Ring groove for optional O-Ring installation.

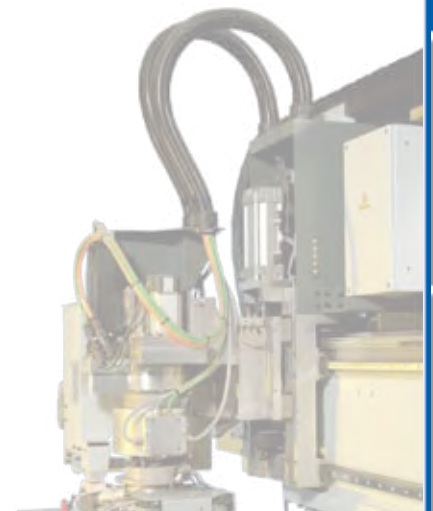



Conduit System

Conduit Fittings: Turn-to-Seal

RoHS

The **Turn-to-Seal** family consists of Conduit Fittings manufactured from high-grade polyamide. This design means that the Fittings offer a high protection rating of IP 65 (NEMA 4). The Fittings are completely pre-assembled and no additional parts such as cap nuts and clamping rings need to be fitted, ensuring reliability in assembly. The cable protection Conduit can be assembled quickly and easily by simply inserting the Conduit and turning the cap nut. The Elbow has smooth inside walls, making the installation of cables & wires easy.

Turn-To-Seal Conduit Fittings

Part Numbers		Thread Type & Size	Fits Nominal Conduit Size	Straight Fitting - Dimensions in Inches (mm)					Elbow - Dimensions in Inches (mm)				
				A	B	C	D	E	F	G	H	I	J
		See page 49 for thread specs		Thread Length	Body Length	Wrench Flat (Body)	Wrench Flat (Dome)	Inside Diameter	Thread Length	Elbow Length	Elbow Height	Wrench Flat (Dome)	Inside Diameter
				ST07AA-BK	-	PG 7	10	.31 (8)	1.02 (26)	.75 (19)	.87 (22)	.31 (8)	-
ST07AR-BK	-	PG 7	8	.31 (8)	1.02 (26)	.75 (19)	.87 (22)	.31 (8)	-	-	-	-	-
ST09AA-BK	ET09AA-BK	PG 9	10	.31 (8)	1.02 (26)	.75 (19)	.87 (22)	.43 (11)	.30 (7.5)	1.77 (45)	1.02 (26)	.87 (22)	.39 (10)
ST11AA-BK	ET11AA-BK	PG 11	12	.31 (8)	1.02 (26)	.87 (22)	.94 (24)	.55 (14)	.31 (8)	2.01 (51)	1.10 (28)	.94 (24)	.51 (13)
ST16AA-BK	ET16AA-BK	PG 16	17	.31 (8)	1.02 (26)	1.06 (27)	1.18 (30)	.67 (17)	.39 (10)	2.20 (56)	1.26 (32)	1.18 (30)	.63 (16)
ST21AA-BK	ET21AA-BK	PG 21	23	.39 (10)	1.38 (35)	1.46 (37)	1.50 (38)	.91 (23)	.43 (11)	2.64 (67)	1.50 (38)	1.50 (38)	.87 (22)
ST29AA-BK	ET29AA-BK	PG 29	29	.39 (10)	1.38 (35)	1.77 (45)	1.81 (46)	1.22 (31)	.47 (12)	3.23 (82)	1.97 (50)	1.81 (46)	1.14 (29)
ST36AA-BK	-	PG 36	37	.59 (15)	1.81 (46)	2.17 (55)	2.40 (61)	1.54 (39)	-	-	-	-	-
ST48AA-BK	-	PG 48	50	.59 (15)	1.97 (50)	2.52 (64)	2.91 (74)	2.01 (51)	-	-	-	-	-
ST11NA-BK	ET11NA-BK	3/8" NPT	12	.55 (14)	1.02 (26)	.87 (22)	.94 (24)	.47 (12)	.31 (8)	2.01 (51)	1.10 (28)	.94 (24)	.51 (13)
ST16NA-BK	ET16NA-BK	1/2" NPT	17	.51 (13)	1.02 (26)	1.06 (27)	1.18 (30)	.55 (14)	.39 (10)	2.20 (56)	1.26 (32)	1.18 (30)	.63 (16)
ST21NA-BK	ET21NA-BK	3/4" NPT	23	.55 (14)	1.38 (35)	1.46 (37)	1.50 (38)	.75 (19)	.43 (11)	2.64 (67)	1.50 (38)	1.50 (38)	.83 (21)
ST29NA-BK	ET29NA-BK	1" NPT	29	.75 (19)	1.38 (35)	1.81 (46)	1.81 (46)	1.02 (26)	.47 (12)	3.23 (82)	1.97 (50)	1.81 (46)	1.06 (27)
ST36NA-BK	-	1-1/4" NPT	37	.71 (18)	1.81 (46)	2.17 (55)	2.40 (61)	1.38 (35)	-	-	-	-	-

ST & ET Fittings are V0 rated & have IP 65 protection without additional parts (O-Ring or Seal Ring).



ST - Straight Conduit Fittings with plastic thread

- Reliable assembly as fitting is supplied pre-assembled. No additional parts required
- Integrated clamping ring ensures high tear-out strength
- High protection to IP 65 (NEMA 4) without additional parts
- Can be opened without tools

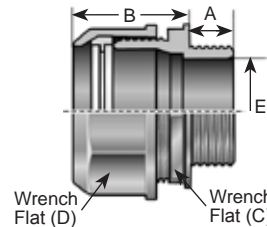

ET - 90° Angled Conduit Fittings with plastic thread

- Reliable assembly as fitting is supplied pre-assembled.
- No additional parts required
- Integrated clamping ring ensures high tear-out strength
- High protection to IP 65 without additional parts
- Can be opened without tools
- Smooth inside walls, therefore easy insertion of the cables into the 90° angle

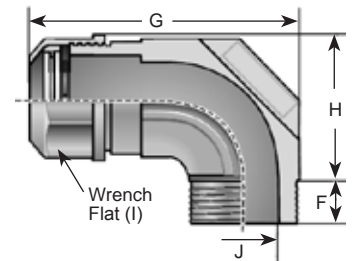

Optional Locking Nuts, O-Rings & Other Accessories starting at page 28.

Advantages:

- High protection rating of IP 65 (NEMA 4)
- One-part fitting
- Rapid assembly
- High pull-out resistance
- Inner contours of 90° fittings are rounded

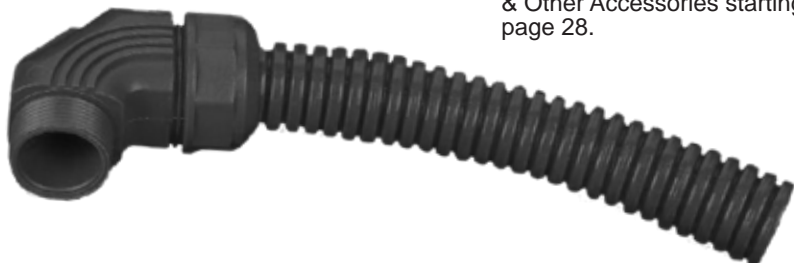



Conduit System Conduit Fittings: Snapclíc DUO

RoHS

- **Combination of Strain Relief & Conduit Fittings**
- **Push-in system**
- **Partially rotatable**
- **Can be equipped with Multi-Hole Inserts**
- **Metal style can be changed to EMI/RFI**

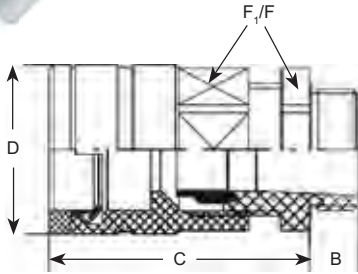

Snapclíc DUO - Nylon									
Part Numbers	Cable Range	Thread Type & Size	Fits Nominal Conduit Size	Dimensions					
				A	B	C	D	F ₁ /F ₂	
	Inches (mm)	See page 49 for thread specs		Hole O.D. + .01" (+.25 mm)	Thread Length	Body Length	Outer Diameter	Wrench Flat	
DUO11AA-BK	.20 - .39 (5 - 10)	PG 11	10	.73 (18.5)	.31 (8)	1.65 (42)	.98 (25)	.87 (22)	
DUO11AR-BK	.12 - .28 (3 - 7)								
DUO13AA-BK	.24 - .47 (6 - 12)	PG 13	12	.80 (20.3)	.35 (9)	1.73 (44)	.98 (25)	.94 (24)	
DUO13AR-BK	.20 - .35 (5 - 9)								
DUO16AA-BK	.39 - .55 (10 - 14)	PG 16	14	.88 (22.3)	.39 (10)	1.81 (46)	1.18 (30)	1.06 (27)	
DUO16AR-BK	.28 - .47 (7 - 12)								
DUO21AA-BK	.51 - .71 (13 - 18)	PG 21	17	1.12 (28.4)	.43 (11)	1.97 (50)	1.38 (35)	1.30 (33)	
DUO21AR-BK	.35 - .63 (9 - 16)								
DUO29AA-BK	.71 - .94 (18 - 24)	PG 29	23	1.47 (37.3)	.43 (11)	2.36 (60)	1.65 (42)	1.65 (42)	
DUO29AR-BK	.51 - .79 (13 - 20)								
DUO36AA-BK	.87 - 1.22 (22 - 31)	PG 36	29	1.85 (47)	.51 (13)	2.36 (60)	1.97 (50)	2.09 (53)	
DUO36AR-BK	.79 - 1.02 (20 - 26)								
DUO16MA-BK	.20 - .39 (5 - 10)	M16 x 1.5	10	.63 (16)	.31 (8)	1.65 (42)	.98 (25)	.87 (22)	
DUO16MR-BK	.12 - .28 (3 - 7)	M20 x 1.5	12	.79 (20)	.35 (9)	1.73 (44)	.98 (25)	.94 (24)	
DUO20MA-BK	.24 - .47 (6 - 12)								
DUO20MR-BK	.20 - .35 (5 - 9)	M20 x 1.5	14	.79 (20)	.39 (10)	1.81 (46)	1.18 (30)	1.06 (27)	
DUO22MA-BK	.39 - .55 (10 - 14)								
DUO22MR-BK	.28 - .47 (7 - 12)	M25 x 1.5	17	.98 (25)	.43 (11)	1.97 (50)	1.38 (35)	1.30 (33)	
DUO25MA-BK	.51 - .71 (13 - 18)								
DUO25MR-BK	.35 - .63 (9 - 16)	M32 x 1.5	23	1.26 (32)	.43 (11)	2.36 (60)	1.65 (42)	1.65 (42)	
DUO32MA-BK	.71 - .94 (18 - 24)								
DUO32MR-BK	.51 - .79 (13 - 20)	M40 x 1.5	29	1.57 (40)	.51 (13)	2.36 (60)	1.97 (50)	2.09 (53)	
DUO40MA-BK	.87 - 1.22 (22 - 31)								
DUO40MR-BK	.79 - 1.02 (20 - 26)								

Snapclíc DUO - Nickel Plated Brass

Part Numbers	Cable Range	Thread Type & Size	Fits Nominal Conduit Size	Dimensions					
				A	B	C	D	F ₁ /F ₂	
	Inches (mm)	See page 49 for thread specs		Hole O.D. + .01" (+.25 mm)	Thread Length	Body Length	Outer Diameter	Wrench Flat	
DUO11AA-BR	.20 - .39 (5 - 10)	PG 11	10	.73 (18.5)	.24 (6)	1.52 (38.5)	.91 (23)	.79 (20)	
DUO11AR-BR	.12 - .28 (3 - 7)								
DUO13AA-BR	.24 - .47 (6 - 12)	PG 13	12	.80 (20.3)	.24 (6)	1.56 (39.5)	.98 (25)	.87 (22)	
DUO13AR-BR	.20 - .35 (5 - 9)								
DUO16AA-BR	.39 - .55 (10 - 14)	PG 16	14	.88 (22.3)	.24 (6)	1.63 (41.5)	1.14 (29)	.94 (24)	
DUO16AR-BR	.28 - .47 (7 - 12)								
DUO21AA-BR	.51 - .71 (13 - 18)	PG 21	17	1.12 (28.4)	.28 (7)	1.75 (44.5)	1.18 (30)	1.18 (30)	
DUO21AR-BR	.35 - .63 (9 - 16)								
DUO29AA-BR	.71 - .94 (18 - 24)	PG 29	23	1.47 (37.3)	.31 (8)	2.07 (52.5)	1.54 (39)	1.57 (40)	
DUO29AR-BR	.51 - .79 (13 - 20)								
DUO36AA-BR	.87 - 1.22 (22 - 31)	PG 36	29	1.85 (47)	.31 (8)	2.32 (59)	1.77 (45)	1.97 (50)	
DUO36AR-BR	.79 - 1.02 (20 - 26)								
DUO16MA-BR	.20 - .39 (5 - 10)	M16 x 1.5	10	.63 (16)	.24 (6)	1.52 (38.5)	.91 (23)	.79 (20)	
DUO16MR-BR	.12 - .28 (3 - 7)								
DUO20MA-BR	.24 - .47 (6 - 12)	M20 x 1.5	12	.79 (20)	.24 (6)	1.56 (39.5)	.98 (25)	.87 (22)	
DUO20MR-BR	.20 - .35 (5 - 9)								
DUO22MA-BR	.39 - .55 (10 - 14)	M20 x 1.5	14	.79 (20)	.24 (6)	1.63 (41.5)	1.14 (29)	.94 (24)	
DUO22MR-BR	.28 - .47 (7 - 12)								
DUO25MA-BR	.51 - .71 (13 - 18)	M25 x 1.5	17	.98 (25)	.28 (7)	1.75 (44.5)	1.18 (30)	1.18 (30)	
DUO25MR-BR	.35 - .63 (9 - 16)								
DUO32MA-BR	.71 - .94 (18 - 24)	M32 x 1.5	23	1.26 (32)	.31 (8)	2.07 (52.5)	1.54 (39)	1.57 (40)	
DUO32MR-BR	.51 - .79 (13 - 20)								
DUO40MA-BR	.87 - 1.22 (22 - 31)	M40 x 1.5	29	1.57 (40)	.31 (8)	2.32 (59)	1.77 (45)	1.97 (50)	
DUO40MR-BR	.79 - 1.02 (20 - 26)								

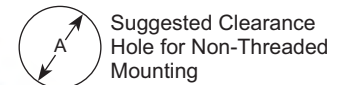

Optional Locking Nuts, O-Rings & Other Accessories starting at page 28.



Pressure Rating:
Installation side - IP 68 (10 bar)
Conduit side - IP 54

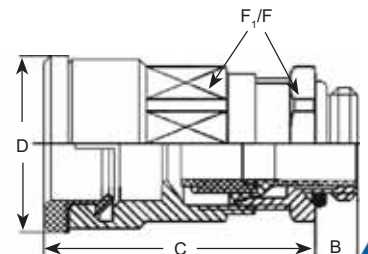

Nylon Strain Relief
Nickel Plated Brass
PVDF / Steel
Accessories
Adapter, Reducer, Enlarger
Conduit System
Technical Information
Other Products / Index



Conduit System

Conduit Fittings: Double-Seal & Bulkhead

RoHS

Double-Seal Fittings

Part Numbers	Thread Type & Size <small>See page 49 for thread specs</small>	Cable Range Inches (mm)	Fits Nominal Conduit Size	Dimensions			
				A	B	C	F ₁ /F
				Hole O.D. <small>+ .01" (+.25 mm)</small>	Thread Length	Body Length	Wrench Flat
DS09AA-BK	PG 9	.16 - .31 (4 - 8)	10	.60 (15.2)	.31 (8)	1.73 (44)	.75 (19) / .87 (22)
DS11AA-BK	PG 11	.20 - .39 (5 - 10)	12	.73 (18.5)	.31 (8)	1.85 (47)	.87 (22) / .95 (24)
DS13AA-BK	PG 13	.24 - .47 (6 - 12)	17	.80 (20.3)	.35 (9)	1.93 (49)	.95 (24) / 1.18 (30)
DS16AA-BK	PG 16	.39 - .55 (10 - 14)	17	.88 (22.3)	.39 (10)	1.97 (50)	1.06 (27) / 1.18 (30)
DS21AA-BK	PG 21	.51 - .71 (13 - 18)	23	1.12 (28.4)	.43 (11)	2.32 (59)	1.30 (33) / 1.50 (38)
<hr/>							
DS09NA-BK	3/8" NPT	.16 - .31 (4 - 8)	10	.68 (17.2)	.59 (15)	2.01 (51)	.75 (19) / .87 (22)
DS13NA-BK	1/2" NPT	.24 - .47 (6 - 12)	17	.83 (21.1)	.51 (13)	2.09 (53)	.95 (24) / 1.18 (30)
DS16NA-BK	1/2" NPT	.39 - .55 (10 - 14)	17	.83 (21.1)	.51 (13)	2.09 (53)	1.06 (27) / 1.18 (30)
DS21NA-BK	3/4" NPT	.51 - .71 (13 - 18)	23	1.05 (26.7)	.51 (13)	2.40 (61)	1.30 (33) / 1.50 (38)
<hr/>							
DS16MA-BK	M16 x 1.5	.16 - .31 (4 - 8)	10	.63 (16)	.31 (8)	1.73 (44)	.75 (19) / .87 (22)
DS20MA-BK	M20 x 1.5	.24 - .47 (6 - 12)	17	.79 (20)	.35 (9)	1.93 (49)	.95 (24) / 1.18 (30)
DS25MA-BK	M25 x 1.5	.51 - .71 (13 - 18)	23	.98 (25)	.43 (11)	2.32 (59)	1.30 (33) / 1.50 (38)

Advantages:

- Combined Conduit and Cable Fitting 2-in-1
- Clamping around entire circumference, ensuring maximum pull-out resistance
- No loose parts - Fitting does not have to be dismantled for assembly
- High degree of protection

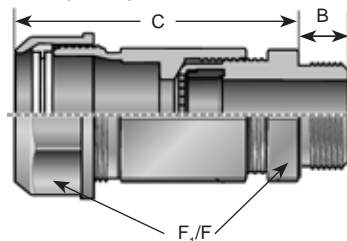

Advantages:

- Split system enables pre-assembled cables to be inserted by means of removable upper part
- Easy assembly
- High stability
- Supplied with gasket for flange connection.
- Internal thread for Metric and PG Fittings



Advantages:

- Split system enables pre-assembled cables to be inserted by means of removable upper part
- Easy assembly
- High stability
- Supplied with gasket for flange connection.
- Conduit remains rotatable

Bulkhead Conduit Fittings with Thread

Part Numbers	Thread Type & Size <small>See page 49 for thread specs</small>	Fits Nominal Conduit Size	Dimensions in Inches (mm)				
			A	B	C	D	E
			Length	Width	Height	Distance between Holes	Hole Diameter
FL-11-BK	PG 11	12	1.93 (49)	1.85 (47)	1.38 (35)	1.46 (37)	.20 (5)
FL-13-BK	PG 16	17	1.93 (49)	1.85 (47)	1.38 (35)	1.46 (37)	.20 (5)
FL-21-BK	PG 21	23	2.72 (69)	2.56 (65)	1.73 (44)	2.05 (52)	.26 (6.5)
FL-29-BK	PG 29	29	3.54 (90)	3.07 (78)	2.17 (55)	2.56 (65)	.28 (7)
FL-36-BK	PG 36	37	3.94 (100)	3.70 (94)	2.60 (66)	3.15 (80)	.28 (7)
FL-48-BK	PG 48	50	4.57 (116)	3.98 (101)	2.99 (76)	3.46 (88)	.28 (7)

Bulkhead Conduit Fittings without Thread

Part Numbers	Fits Nominal Conduit Size	Dimensions in Inches (mm)				
		A	B	C	D	E
		Length	Width	Height	Distance between Holes	Hole Diameter
FT-11-BK	12	1.93 (49)	1.85 (47)	1.38 (35)	1.46 (37)	.20 (5)
FT-13-BK	17	1.93 (49)	1.85 (47)	1.38 (35)	1.46 (37)	.20 (5)
FT-21-BK	23	2.72 (69)	2.56 (65)	1.73 (44)	2.05 (52)	.26 (6.5)
FT-29-BK	29	3.54 (90)	3.07 (78)	2.17 (55)	2.56 (65)	.28 (7)
FT-36-BK	37	3.94 (100)	3.70 (94)	2.60 (66)	3.15 (80)	.28 (7)
FT-48-BK	50	4.57 (116)	3.98 (101)	2.99 (76)	3.46 (88)	.28 (7)

Note: Screws not included.

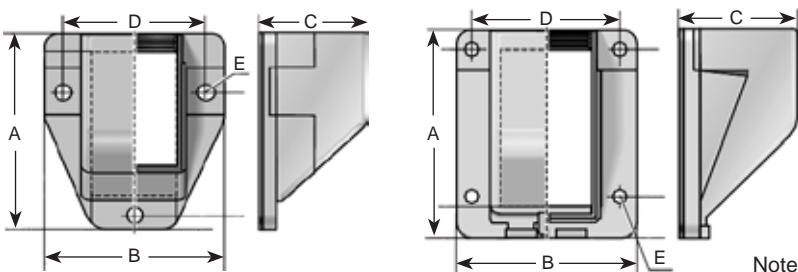

(up to M25 / PG 21)

(from M32 / PG 29)

(Technical Drawings apply to both types of Bulkhead Fittings)

Bulkhead Fittings are manufactured from high-grade polyamide.
Split system: large cut-out size allows for quick & easy insertion of pre-assembled cables into a housing.
Protection rating: IP 54 or IP 65.
The higher IP 65 protection rating is achieved in combination with a suitable Conduit Fitting.

Note: The design of the Bulkhead Fittings changes depending on size. Up to M25/PG 21 the Fitting has 3 screw holes, from size M32 / PG 29 the Fitting has 4 screw holes. (see technical drawings)