



# TYPE XLSK AC MOTOR STARTERS

## 3 Phase Full Voltage-Across the Line



All Starters Supplied with BUILT-IN HEATERS Size 00-2 CE NEMA RATED

AC-1	AC-3	Horse Power (UL) Ratings 3 Phase Motor Max UL HP Volts	OPEN	ENCLOSED					NEMA HP ★
				NEMA 1 General Purpose	NEMA 4X Outdoor (non-metal)	NEMA 4 (metal)	NEMA 3R (metal)	NEMA 12 Dust Tight (metal)	
20	9	200V 3 HP 230V 3 HP 460V 5 HP	XLS05 See page 77					See Below	
25	12	200V 3 HP 230V 3 HP 460V 7.5 HP 600V 10 HP	XLS5K -★0-★★	XLS5K -★1-★★	XLS5K -★4x-★★	XLS5K -★4-★★	XLS5K -★3R-★★	XLS5K -★12-★★	200V 1.5 HP 230V 1.5 HP 460V 2 HP 600V 2 HP NEMA 00
		LIST	\$142	\$216	\$267	\$287	\$247	\$247	
32	18	200V 5 HP 230V 5 HP 460V 10 HP 600V 15 HP	XLS7K -★0-★★	XLS7K -★1-★★	XLS7K -★4x-★★	XLS7K -★4-★★	XLS7K -★3R-★★	XLS7K -★12-★★	
		LIST	\$145	\$217	\$270	\$290	\$250	\$250	
45	25	200V 5 HP 230V 7.5 HP 460V 15 HP 600V 15 HP	XLS11K -★0-★★	XLS11K -★1-★★	XLS11K -★4x-★★	XLS11K -★4-★★	XLS11K -★3R-★★	XLS11K -★12-★★	200V 3 HP 230V 3 HP 460V 5 HP 600V 5 HP NEMA 0
		LIST	\$170	\$242	\$295	\$315	\$275	\$275	
60	32	200V 10 HP 230V 10 HP 460V 20 HP 600V 25 HP	XLS15K -★0-★★	XLS15K -★1-★★	XLS15K -★4x-★★	XLS15K -★4-★★	XLS15K -★3R-★★	XLS15K -★12-★★	
		LIST	\$220	\$292	\$345	\$355	\$315	\$315	
60	40	200V 10 HP 230V 10 HP 460V 25 HP 600V 25 HP	XLS18K -★0-★★	XLS18K -★1-★★	XLS18K -★4x-★★	XLS18K -★4-★★	XLS18K -★3R-★★	XLS18K -★12-★★	200V 7.5 HP 230V 7.5 HP 460V 10 HP 600V 10 HP NEMA 1
		LIST	\$260	\$332	\$385	\$400	\$355	\$355	
90	50	200V 15 HP 230V 15 HP 460V 30 HP 600V 40 HP	XLS22K -★0-★★	XLS22K -★1-★★	XLS22K -★4x-★★	XLS22K -★4-★★	XLS22K -★3R-★★	XLS22K -★12-★★	
		LIST	\$285	\$375	\$441	\$447	\$389	\$389	
110	65	200V 20 HP 230V 20 HP 460V 40 HP 600V 50 HP	XLS30K -★0-★★	XLS30K -★1-★★	XLS30K -★4x-★★	XLS30K -★4-★★	XLS30K -★3R-★★	XLS30K -★12-★★	
		LIST	\$386	\$476	\$542	\$690	\$488	\$499	
110	80	200V 20 HP 230V 25 HP 460V 50 HP 600V 60 HP	XLS37K -★0-★★	XLS37K -★1-★★	XLS37K -★4x-★★	XLS37K -★4-★★	XLS37K -★3R-★★	XLS37K -★12-★★	200V 10 HP 230V 15 HP 460V 25 HP 600V 25 HP NEMA 2
		LIST	\$421	\$511	\$577	\$780	\$540	\$540	

Modifications and accessories are listed on pages 65, 68. dimensions page 70

Steps To Order Motor Starter:	
<b>Step 1-Size</b>	Choose from the UL HP and Voltage list per your application. For example: 5 HP 230V 3 phase part # XLS7K.
<b>Step 2 - Coil*</b>	From the coil suffix chart on the next page choose the suffix for your control circuit voltage requirement.(Example: 24VAC = G-) (Part # XLS7K-G)
<b>Step 3 -Enclosure</b>	specify "open" or "enclosed" requirements. For example if NEMA 12 (part # XLS7K-G12-).
<b>Step 4 -Overload Amps**</b>	This step requires a suffix for your overload protection, refer to "OVERLOAD RELAY SUFFIX TABLE" (Example: 5HP @ 230V 3 Phase,if 13 Full Load Amps = suffix "N".) Example: XLS7K - G12 - N

** Overload Relay Suffix				
Suffix	O.L. Relay Setting Range		O.L. Relay Setting Range	
	(Amps)		(Amps)	
-B	0.16-0.26	-ON	21-26	
-C	0.26-0.41	-P	25-32	
-D	0.4-0.65	-Q	30-40	
-E	0.65-1.1	-QN	42-55	
-F	1.1-1.5	-RN	54-65	
-G	1.3-1.9	-SN	64-82	
-H	1.8-2.7	-TM	78-97	
-I	2.5-4	-TN	90-110	
-K	4-6.3	-TT	110-140	
-L	5.5-8.5	-U	140-190	
-M	8-12	-V	175-280	
-N	10-16	-W	200-310	
-O	14.5-18	-WT	250-400	
-OM	17.5-22	-X	315-500	
		-Y	430-700	





# TYPE XLSK AC STARTERS

## 3 Phase Full Voltage-Across the Line



All Starters Supplied with BUILT-IN HEATERS    Size 3-5   

NEMA RATED

AC-1	AC-3	Horse Power Ratings 3 Phase Motor Max UL Volts    HP		OPEN	ENCLOSED					NEMA HP
					NEMA 1 General Purpose (metal)	NEMA 4X Outdoor Dust Tight (non metal)	NEMA 4 (metal)	NEMA3R Rain Tight (metal)	NEMA12 Dust Tight (metal)	
140	95	200V    25 HP	XLS45K	XLS45K	XLS45K	XLS45K	XLS45K	XLS45K	XLS45K	
		230V    30 HP		-*0-**	-*1-**	-*4x-**	-*4-**	-*3R-**	-*12-**	
		460V    60 HP								
		600V    75 HP								
		LIST	\$535	\$638	\$735	\$994	\$708	\$708		
140	105	200V    30 HP	XLS55K	XLS55K	XLS55K	XLS55K	XLS55K	XLS55K	XLS55K	200V 25 HP 230V 30 HP 460V 50 HP 600V 50 HP <b>NEMA 3</b>
		230V    40 HP		-*0-**	-*1-**	-*4x-**	-*4-**	-*3R-**	-*12-**	
		460V    75 HP								
		600V    75 HP								
		LIST	\$625	\$777	\$1,302	\$1,532	\$1,332	\$1,332		
250	150	200V    40 HP	XLS75K	XLS75K	XLS75K	XLS75K	XLS75K	XLS75K	XLS75K	
		230V    50 HP		-*0-**	-*1-**	-*4x-**	-*4-**	-*3R-**	-*12-**	
		460V    100 HP								
		600V    125 HP								
		LIST	\$1,020	\$1,330	\$1,720	\$1,840	\$1,840	\$1,840		
250	185	200V    50 HP	XLS90K	XLS90K	XLS90K	XLS90K	XLS90K	XLS90K	XLS90K	200V 40 HP 230V 50 HP 460V 100 HP 600V 100 HP <b>NEMA 4</b>
		230V    60 HP		-*0-**	-*1-**	-*4x-**	-*4-**	-*3R-**	-*12-**	
		460V    125 HP								
		600V    150 HP								
		LIST	\$1,270	\$1,580	\$1,970	\$2,308	\$2,072	\$2,072		
315	205	200V    60 HP	XLS110K	XLS110K	XLS110K	XLS110K	XLS110K	XLS110K	XLS110K	
		230V    75 HP		-*0-**	-*1-**	-*4x-**	-*4-**	-*3R-**	-*12-**	
		460V    150HP								
		600V    150HP								
		LIST	\$1,550	\$2,275	\$3,250	\$2,777	\$2,404	\$2,404		
315	250	200V    60 HP	XLS132K	XLS132K	XLS132K	XLS132K	XLS132K	XLS132K	XLS132K	
		230V    75HP		-*0-**	-*1-**	-*4x-**	-*4-**	-*3R-**	-*12-**	
		460V    150HP								
		600V    150HP								
		LIST	\$1,660	\$2,385	\$3,360	\$2,928	\$2,555	\$2,555		
450	309	200V    100 HP	XLS160K	XLS160K	XLS160K	XLS160K	XLS160K	XLS160K	XLS160K	200V 75 HP 230V 100 HP 460V 200 HP 600V 200 HP <b>NEMA 5</b>
		230V    100HP		-*0-**	-*1-**	-*4x-**	-*4-**	-*3R-**	-*12-**	
		460V    250 HP								
		600V    300HP								
		LIST	\$1,860	\$2,585	\$3,560	\$3,079	\$2,706	\$2,706		
600	420	200V    125HP	XLS220K	XLS220K	XLS220K	XLS220K	XLS220K	XLS220K	XLS220K	
		230V    150HP		-*0-**	-*1-**	-*4x-**	-*4-**	-*3R-**	-*12-**	
		460V    300HP								
		600V    400HP								
		LIST	\$2,323	\$3,623	\$4,023	\$5,848	\$4,080	\$4,080		
700	550	200V    150HP	XLS280K	XLS280K	XLS280K	XLS280K	XLS280K	XLS280K	XLS280K	
		230V    200HP		-*0-**	-*1-**	-*4x-**	-*4-**	-*3R-**	-*12-**	
		460V    400HP								
		600V    500HP								
		LIST	\$3,310	\$4,750	\$5,010	\$8,926	\$5,270	\$5,270		

For LS4K-LS18K (3 pole)			
AC	60Hz	50HZ	
-G	24	24	24
-A	120	120	120
-B	200	200	200
-C	220	220	220
-H	277	230	230
-E	480	380	380
-F	600	500	500
DC add \$30 to list			
-MSW	12 VDC		
-NSW	24VDC		
-OSW	48 VDC		
-PSW	110 VDC		
-RSW	220 VDC		

For LS22K-LS55K (3 pole)			
AC	60Hz	50HZ	
-G	24	24	24
-A	120	120	120
-B	200	200	200
-C	220	220	220
-H	277	230	230
-E	480	380	380
-F	600	500	500
DC add \$40 to list			
-NSW	24-28 VDC		
-OSW	42-48 VDC		
-PSW	110-127 VDC		
-RSW	220-250 VDC		

For LS75K-LS375K (3 Pole)	
AC/DC	50/60 Hz + DC
-N	24-28V
-AP	110-127V
-CR	220-250V
-EX	440-500V

\* Coil Suffix

No Addition for DC above.

Part # Example: XLS45K:  
XLS45K= Size LS45K Contactor  
A= 120 VAC Coil  
I= NEMA 1 Enclosure  
Q= 30-40 Amps

** Overload Relay Suffix			
O.L. Relay Setting Range		O.L. Relay Setting Range	
Suffix	(Amps)	Suffix	(Amps)
-B	0.16-0.26	-ON	21-26
-C	0.25-0.41	-P	25-32
-D	0.4-0.65	-Q	30-47
-E	0.65-1.1	-QN	42-55
-F	1.1-1.5	-RN	54-65
-G	1.3-1.9	-SN	64-82
-H	1.8-2.7	-TM	78-97
-I	2.5-4	-TN	90-110
-K	4-6.3	-TT	110-140
-L	5.5-8.5	-U	140-190
-M	8-12	-V	175-280
-N	10-16	-W	200-310
-O	14.5-18	-WT	250-400
-OM	17.5-22	-X	315-500





# Single Phase Starters Open and Enclosed Types



**NEMA 1 Open Starter**  
(Type SXLS7K 3HP 230V)



**NEMA 1 Enclosed**  
(Type SXLS7K 3HP 230V)



**NEMA 4X Enclosed**  
start/stop operator

AEG Maximum H.P. is a conservative rating fully equivalent to or surpassing NEMA ratings. Mechanical life is 10,000,000 operations with electrical life approximately 1,000,000 operations at full rated Horse Power.

EE Controls size grouping were designed to match logical motor horse power groupings as used throughout industry. As such, more sizes are offered than the NEMA industry. Each unit fully meets applicable codes and can be applied per the NEC code.

More sizes allows users to closer match their motor and drives package with the result of substantial cost and space savings.

In industry, the metal General Purpose NEMA 1 enclosure is the most widely used and versatile design. As standard, a selection of knockouts are provided on all sides for conduit entry and for field start - stop kit or selector switch additions.

**Type 4X Enclosed Starters.** NEMA 4X starters are UL / CSA listed starters enclosed in type 4X U.L. listed enclosures. Type 4X enclosures are designed for outdoor / hose down/ dust tight applications and are non-metal corrosion resistant.

See next page 34 for \* Coil Voltage Suffix & \*\* Overload Suffix page 47

UL HP Rating 1 Phase Motors 115V HP    230V HP		OPEN	NEMA 1 General Purpose (Metal)	NEMA 4X Outdoor Dust Tight (Non-metal)	NEMA 4 (Metal)	NEMA 3R Rain Tight (Metal)	NEMA 12 Dust Tight (Metal)
1/2	1 1/2	See Page 77					
3/4	2	SXLS5K -*0-** \$142	SXLS5K -*1-** \$216	SXLS5K -4X-** \$267	SXLS5K -*4-** \$287	SXLS5K -*3R-** \$247	SXLS5K -*12-** \$247
1	3	SXLS7K -*0-** \$145	SXLS7K -*1-** \$217	SXLS7K -4X-** \$270	SXLS7K -*4-** \$290	SXLS7K -*3R-** \$250	SXLS7K -*12-** \$250
1 1/2	3	SXLS11K -*0-** \$170	SXLS11K -*1-** \$242	SXLS11K -4X-** \$295	SXLS11K -*4-** \$315	SXLS11K -*3R-** \$275	SXLS11K -*12-** \$275
2	5	SXLS15K -*0-** \$220	SXLS15K -*1-** \$292	SXLS15K -4X-** \$345	SXLS15K -*4-** \$355	SXLS15K -*3R-** \$315	SXLS15K -*12-** \$315
3	5	SXLS18K -*0-** \$260	SXLS18K -*1-** \$332	SXLS18K -4X-** \$385	SXLS18K -*4-** \$400	SXLS18K -*3R-** \$355	SXLS18K -*12-** \$355
3	7 1/2	SXLS22K -*0-** \$285	SXLS22K -*1-** \$375	SXLS22K -4X-** \$441	SXLS22K -4-** \$447	SXLS22K -*3R-** \$389	SXLS22K -*12-** \$389
5	10	SXLS30K -*0-** \$386	SXLS30K -*1-** \$476	SXLS30K -4X-** \$542	SXLS30K -*4-** \$690	SXLS30K -*3R-** \$499	SXLS30K -*12-** \$499
7 1/2	15	SXLS45K -*0-** \$535	SXLS45K -*1-** \$638	SXLS45K -4X-** \$735	SXLS45K -*4-** \$994	SXLS45K -*3R-** \$708	SXLS45K -*12-** \$708
10	20	SXLS55K -*0-** \$625	SXLS55K -*1-** \$777	SXLS55K -4X-** \$1,302	SXLS55K -*4-** \$1,532	SXLS55K -*3R-** \$1,332	SXLS55K -*12-** \$1,332





# SINGLE PHASE REVERSING STARTERS 1Ø



**AEG**

### Single Phase Reversing Starter Controls (Included)

- A) All RSXLSK Series Reversing Starters are cUL Approved.
- B) All Reversing Starters Include Thru Door Reset as Standard.
- C) Type RSXLSK Starters Have Precision Ambient Compensated heaters. (25°C - +60°C) - 11°F - +140°F

### Steps To Order Motor Starter:

- Step 1 - Size** Choose from the UL HP and Voltage list per your application. For example: 5 HP 230V Single Phase Reversing Starter (Example: RSXLS15K-)
- Step 2 - Coil\*** From the coil suffix chart below. Choose your control circuit voltage requirement. (Example: 24VAC = G-) RSXLS15K-G
- Step 3 - Enclosure** specify "open" or "enclosed" requirements. For example if NEMA 12 (part # RSXLS15K-G12-)
- Step 4 - Overload Amps\*\*** This step requires a suffix for your overload protection, refer to "OVERLOAD RELAY SUFFIX TABLE" (Example: 5HP @ 230V Single Phase, if 28 Full Load Amps = suffix "P") Example: RSXLS15K-G12-P For additional options see page 7

Size	NEMA Horse Power Ratings 1 Phase Motors		OPEN	NEMA 1 General Purpose (metal)	NEMA 4X Outdoor Dust Tight (non metal)	NEMA 4 (metal)	NEMA 3R Raintight (metal)	NEMA 12 Dust Tight (metal)
	115V HP	230V HP						
MINI LIST	1/2	1	RSXLS05 See Page 77					
00 LIST	3/4	2	RSXLS5K -*0-*** \$262	RSXLS5K -*1-*** \$352	RSXLS5K -*4X-*** \$418	RSXLS5K -*4-*** \$451	RSXLS5K -*3R-*** \$398	RSXLS5K -*12-*** \$441
LIST	1	3	RSXLS7K -*0-*** \$273	RSXLS7K -*1-*** \$363	RSXLS7K -*4X-*** \$429	RSXLS7K -*4-*** \$465	RSXLS7K -*3R-*** \$412	RSXLS7K -*12-*** \$455
0 LIST	1 <sup>1/2</sup>	3	RSXLS11K -*0-*** \$308	RSXLS11K -*1-*** \$398	RSXLS11K -*4X-*** \$464	RSXLS11K -*4-*** \$499	RSXLS11K -*3R-*** \$424	RSXLS11K -*12-*** \$489
LIST	2	5	RSXLS15K -*0-*** \$418	RSXLS15K -*1-*** \$508	RSXLS15K -*4X-*** \$574	RSXLS15K -*4-*** \$608	RSXLS15K -*3R-*** \$568	RSXLS15K -*12-*** \$598
1 LIST	3	5	RSXLS18K -*0-*** \$463	RSXLS18K -*1-*** \$453	RSXLS18K -*4X-*** \$619	RSXLS18K -*4-*** \$750	RSXLS18K -*3R-*** \$705	RSXLS18K -*12-*** \$740
LIST	3	7 1/2	RSXLS22K -*0-*** \$524	RSXLS22K -*1-*** \$734	RSXLS22K -*4X-*** \$799	RSXLS22K -*4-*** \$985	RSXLS22K -*3R-*** \$784	RSXLS22K -*12-*** \$975
LIST	5	10	RSXLS30K -*0-*** \$674	RSXLS30K -*1-*** \$884	RSXLS30K -*4X-*** \$949	RSXLS30K -*4-*** \$1,170	RSXLS30K -*3R-*** \$897	RSXLS30K -*12-*** \$1,160
2 LIST	5	15	RSXLS37K -*0-*** \$768	RSXLS37K -*1-*** \$978	RSXLS37K -*4X-*** \$1,259	RSXLS37K -*4-*** \$1,255	RSXLS37K -*3R-*** \$982	RSXLS37K -*12-*** \$1,245

### \* Coil Suffix Chart

For LS4K-LS18K (3 pole)		
AC	60Hz	50Hz
-G	24	24
-A	120	120
-B	200	200
-C	220	220
-H	277	230
-E	480	380
-F	600	500

DC add \$80 to list	
-MSW	12 VDC
-NSW	24VDC
-OSW	48 VDC
-PSW	110 VDC
-RSW	220 VDC

For LS22K-LS55K (3 pole)		
AC	60Hz	50Hz
-G	24	24
-A	120	120
-B	200	200
-C	220	220
-H	277	230
-E	480	380
-F	600	500

DC add \$120 to list	
-NSW	24-28 VDC
-OSW	42-48 VDC
-PSW	110-127 VDC
-RSW	220-250 VDC

For LS75K-LS375K (3 Pole)	
AC/DC	50/60 Hz + DC
-N	24-28V
-AP	110-127V
-CR	220-250V
-EX	440-500V

No Addition for DC above.  
Coil Tolerance for AC/DC coils are less 20% - +10% of nominal Voltage.  
= If unsure of overload Suffix & only know HP and voltage see Modification & Accessories 65, 68 chart on the back inside cover.

** Overload Relay Suffix			
O.L. Relay Setting Range		O.L. Relay Setting Range	
Suffix	(Amps)	Suffix	(Amps)
-B	0.16-0.26	-ON	21-26
-C	0.25-0.41	-P	25-32
-D	0.4-0.65	-Q	30-43
-E	0.65-1.1	-ON	42-55
-F	1.1-1.5	-RN	54-65
-G	1.3-1.9	-SN	64-82
-H	1.8-2.7	-TM	78-97
-I	2.5-4	-TN	90-110
-K	4-6.3	-TT	110-140
-L	5.5-8.5	-U	140-190
-M	8-12	-V	175-280
-N	10-16	-W	200-310
-O	14.5-18	-WT	250-400
-OM	17.5-22	-X	315-500

Modification & Accessories 65, 68 chart on the back inside cover.

Discount Schedule ST





# TYPE RXLSK AC REVERSING STARTERS 3 PHASE FULL VOLTAGE



All Starters Supplied with BUILT-IN HEATERS

Size 00-2



NEMA RATED

AC-1 AMPS	AC-3 AMPS	Horse Power (UL) Ratings 3 Phase Motor Max UL HP	OPEN	ENCLOSED					Comparable NEMA HP NEMA Size
				NEMA 1 General Purpose	NEMA 4X Outdoor (non-metal)	NEMA 4 (metal)	NEMA 3R (metal)	NEMA 12 Dust Tight (metal)	
20A	9A	200V 3 HP 230V 3 HP 460V 5 HP 600V 5 HP	<b>See Page 77</b>						
25A	9A	200V 3 HP 230V 3 HP 460V 5 HP 600V 7.5 HP LIST	RXLS4K -*0-*	RXLS4K -*1-*	RXLS4K -*4x-*	RXLS4K -*4-*	RXLS4K -*3R-*	RXLS4K -*12-*	
			\$238	\$328	\$394	\$437	\$375	\$427	
25A	12A	200V 3 HP 230V 3 HP 460V 7.5 HP 600V 10 HP LIST	RXLS5K -*0-*	RXLS5K -*1-*	RXLS5K -*4x-*	RXLS5K -*4-*	RXLS5K -*3R-*	RXLS5K -*12-*	200V 1.5 HP 230V 1.5 HP 460V 2 HP 600V 2 HP NEMA 00
			\$262	\$352	\$418	\$451	\$398	\$441	
32A	18A	200V 5 HP 230V 5 HP 460V 10 HP 600V 15 HP LIST	RXLS7K -*0-*	RXLS7K -*1-*	RXLS7K -*4x-*	RXLS7K -*4-*	RXLS7K -*3R-*	RXLS7K -*12-*	
			\$273	\$363	\$429	\$465	\$412	\$455	
45A	25A	200V 5 HP 230V 7.5 HP 460V 15 HP 600V 15 HP LIST	RXLS11K -*0-*	RXLS11K -*1-*	RXLS11K -*4x-*	RXLS11K -*4-*	RXLS11K -*3R-*	RXLS11K -*12-*	200V 3 HP 230V 3 HP 460V 5 HP 600V 5 HP NEMA 0
			\$308	\$398	\$464	\$499	\$424	\$489	
60A	32A	200V 10 HP 230V 10 HP 460V 20 HP 600V 25 HP LIST	RXLS15K -*0-*	RXLS15K -*1-*	RXLS15K -*4x-*	RXLS15K -*4-*	RXLS15K -*3R-*	RXLS15K -*12-*	
			\$418	\$508	\$574	\$608	\$568	\$598	
60A	40A	200V 10 HP 230V 10 HP 460V 25 HP 600V 25 HP LIST	RXLS18K -*0-*	RXLS18K -*1-*	RXLS18K -*4x-*	RXLS18K -*4-*	RXLS18K -*3R-*	RXLS18K -*12-*	200V 7.5 HP 230V 7.5 HP 460V 10 HP 600V 10 HP NEMA 1
			\$463	\$553	\$619	\$750	\$705	\$740	
90A	50A	200V 15 HP 230V 15 HP 460V 30 HP 600V 40 HP LIST	RXLS22K -*0-*	RXLS22K -*1-*	RXLS22K -*4x-*	RXLS22K -*4-*	RXLS22K -*3R-*	RXLS22K -*12-*	
			\$524	\$734	\$799	\$985	\$784	\$975	
110A	65A	200V 20 HP 230V 20 HP 460V 40 HP 600V 50 HP LIST	RXLS30K -*0-*	RXLS30K -*1-*	RXLS30K -*4x-*	RXLS30K -*4-*	RXLS30K -*3R-*	RXLS30K -*12-*	
			\$674	\$884	\$949	\$1,170	\$897	\$1,160	
110A	80A	200V 20 HP 230V 25 HP 460V 50 HP 600V 60 HP LIST	RXLS37K -*0-*	RXLS37K -*1-*	RXLS37K -*4x-*	RXLS37K -*4-*	RXLS37K -*3R-*	RXLS37K -*12-*	200V 10 HP 230V 15 HP 460V 25 HP 600V 25 HP NEMA 2
			\$768	\$978	\$1,259	\$1,255	\$982	\$1,245	

### Steps To Order Motor Starter:

**Step 1-Size** Choose from the UL HP and Voltage list per your application.  
For example: 5 HP 230V 3 phase part # RXLS7K.

**Step 2 - Coil\*** From the coil suffix chart on the next page choose the suffix for your control circuit voltage requirement. (Example: 24VAC = G-) (Part # RXLS7K-G)

**Step 3 -Enclosure** specify "open" or "enclosed" requirements.  
For example if NEMA 12 (part #RXLS7K-G12-).

**Step 4 -Overload Amps\*\*** This step requires a suffix for your overload protection, refer to "OVERLOAD RELAY SUFFIX TABLE" (next page)  
(Example: 5HP @ 230V 3 Phase, if 13 Full Load Amps = suffix "N".)  
Example: RXLS7K-G12-N

### RXLSK Series Starters

- (what's included?)
- AEG 3 Phase Reversing Starters.
- (Ambient compensated Bi metallic windings).
- -25°C - +60°C (-11.20°F - +140°F).
- Overload Class 10 (adjustable heaters).
- Electrical & Mechanical interlocks as standard.
- Thru door reset. Enclosed units only).

Modifications and accessories are listed on pages 65, 68

For Operators, Transformers & Accessories see page 60





# TYPE RXLSK AC REVERSING STARTERS

## 3 Phase Full Voltage-Across the Line



All Starters Supplied with BUILT-IN HEATERS Size 3-5

NEMA RATED

AC-1 AMPS	AC-3 AMPS	Horse Power Ratings 3 Phase Motor Max UL Volts HP	OPEN	ENCLOSED					NEMA HP
				NEMA 1 General Purpose (metal)	NEMA 4X Outdoor Dust Tight (non metal)	NEMA 4 (metal)	NEMA3R Rain Tight (metal)	NEMA12 Dust Tight (metal)	
140A	95A	200V 25 HP 230V 30 HP 460V 60 HP 600V 75 HP	RXLS45K -★0-★★	RXLS45K -★1-★★	RXLS45K -★4x-★★	RXLS45K -★4-★★	RXLS45K -★3R-★★	RXLS45K -★12-★★	
		LIST	\$948	\$1,206	\$1,301	\$1,450	\$1,199	\$1,440	
140A	105A	200V 30 HP 230V 40 HP 460V 75 HP 600V 75 HP	RXLS55K -★0-★★	RXLS55K -★1-★★	RXLS55K -★4x-★★	RXLS55K -★4-★★	RXLS55K -★3R-★★	RXLS55K -★12-★★	200V 25 HP 230V 30 HP 460V 50 HP 600V 50 HP NEMA 3
		LIST	\$1,128	\$1,386	\$1,481	\$1,850	\$1,395	\$1,840	
250A	150A	200V 40 HP 230V 50 HP 460V 100 HP 600V 125 HP	RXLS75K -★0-★★	RXLS75K -★1-★★	RXLS75K -★4x-★★	RXLS75K -★4-★★	RXLS75K -★3R-★★	RXLS75K -★12-★★	
		LIST	\$1,890	\$2,200	\$2,590	\$2,675	\$2,464	\$2,665	
250A	185A	200V 50 HP 230V 60 HP 460V 125 HP 600V 150 HP	RXLS90K -★0-★★	RXLS90K -★1-★★	RXLS90K -★4x-★★	RXLS90K -★4-★★	RXLS90K -★3R-★★	RXLS90K -★12-★★	200V 40 HP 230V 50 HP 460V 100 HP 600V 100HP NEMA 4
		LIST	\$2,390	\$2,700	\$3,090	\$3,425	\$2,884	\$3,415	
315A	205A	200V 60 HP 230V 75 HP 460V 150HP 600V 150HP	RXLS110K -★0-★★	RXLS110K -★1-★★	RXLS110K -★4x-★★	RXLS110K -★4-★★	RXLS110K -★3R-★★	RXLS110K -★12-★★	
		LIST	\$2,858	\$3,583	\$4,558	\$4,413	\$4,090	\$4,403	
315A	250A	200V 60 HP 230V 75HP 460V 150HP 600V 150HP	RXLS132K -★0-★★	RXLS132K -★1-★★	RXLS132K -★4x-★★	RXLS132K -★4-★★	RXLS132K -★3R-★★	RXLS132K -★12-★★	
		LIST	\$2,930	\$3,655	\$4,630	\$4,680	\$4,162	\$4,670	
450A	309A	200V 100 HP 230V 100HP 460V 250 HP 600V 300HP	RXLS160K -★0-★★	RXLS160K -★1-★★	RXLS160K -★4x-★★	RXLS160K -★4-★★	RXLS160K -★3R-★★	RXLS160K -★12-★★	200V 75 HP 230V 100 HP 460V 200 HP 600V 200 HP NEMA 5
		LIST	\$3,393	\$4,118	\$5,093	\$4,830	\$4,250	\$4,820	
600A	420A	200V 125HP 230V 150HP 460V 300HP 600V 400HP	RXLS220K -★0-★★	RXLS220K -★1-★★	RXLS220K -★4x-★★	RXLS220K -★4-★★	RXLS220K -★3R-★★	RXLS220K -★12-★★	
		LIST	\$4,210	\$5,510	\$5,910	\$6,673	\$6,599	\$6,663	
700A	550A	200V 150HP 230V 200HP 460V 400HP 600V 500HP	RXLS280K -★0-★★	RXLS280K -★1-★★	RXLS280K -★4x-★★	RXLS280K -★4-★★	RXLS280K -★3R-★★	RXLS280K -★12-★★	
		LIST	\$6,210	\$7,510	\$7,910	\$8,673	\$8,488	\$8,663	

\* Coil Suffix

For LS4K-LS18K (3 pole)		
AC	60Hz	50HZ
-G	24	24
-A	120	120
-B	200	200
-C	220	220
-H	277	230
-E	480	380
-F	600	500
DC add \$60 to list		
-MSW	12 VDC	
-NSW	24VDC	
-OSW	48 VDC	
-PSW	110 VDC	
-RSW	220 VDC	

For LS22K-LS55K (3 pole)		
AC	60Hz	50HZ
-G	24	24
-A	120	120
-B	200	200
-C	220	220
-H	277	230
-E	480	380
-F	600	500
DC add \$120 to list		
-NSW	24-28 VDC	
-OSW	42-48 VDC	
-PSW	110-127 VDC	
-RSW	220-250 VDC	

For LS75K-LS375K (3 Pole)	
AC/DC	50/60 Hz + DC
-N	24-28V
-AP	110-127V
-CR	220-250V
-EX	440-500V

No Addition for DC above.

Part # Example: XLS45K:  
XLS45K= Size LS45K Contactor  
A= 120 VAC Coil  
E= NEMA 1 Enclosure  
Q= 30-43 Amps

Complete Part Number:  
XLS45K-AI-Q

** Overload Relay Suffix			
O.L. Relay Setting Range	O.L. Relay Setting Range		
Suffix (Amps)	Suffix (Amps)		
-B	0.16-0.26	-ON	21-26
-C	0.25-0.41	-P	25-32
-D	0.4-0.65	-Q	30-43
-E	0.65-1.1	-QN	42-55
-F	1.1-1.5	-RN	54-65
-G	1.3-1.9	-SN	64-82
-H	1.8-2.7	-TM	78-97
-I	2.5-4	-TN	90-110
-K	4-6.3	-TT	110-140
-L	5.5-8.5	-U	140-190
-M	8-12	-V	175-280
-N	10-16	-W	200-310
-O	14.5-18	-WT	250-400
-OM	17.5-22	-X	315-500

Discount Schedule ST

Modification & Accessories  
See Page 65, 68.

For Technical Details on Reversing Starters See Page 54, 57, 72, 73

# XLS Starter Drawings

## AC Operated \*

XLS4K, XLS5K, XLS7K

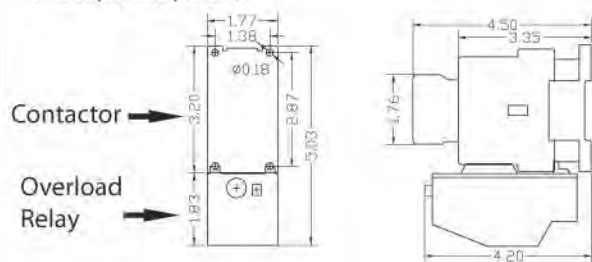

XLS11K

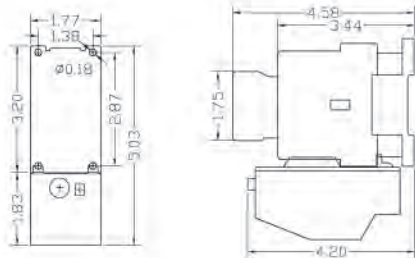

XLS15K, 18K

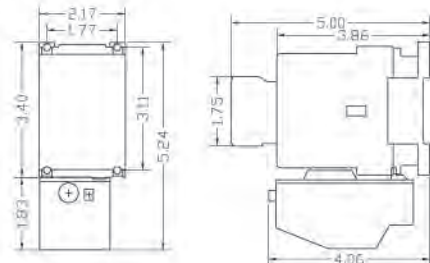

XLS22K, 30K, 37K

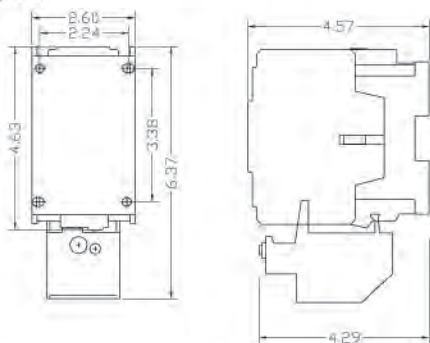

XLS45K, 55K

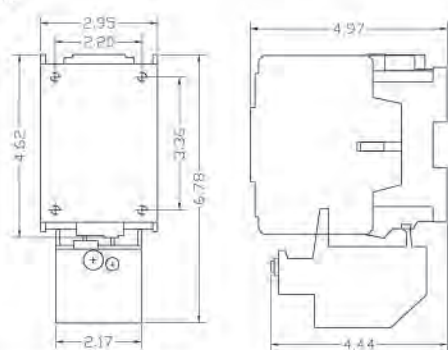

## DC Operated \*

XLS4K, XLS5K, XLS7K

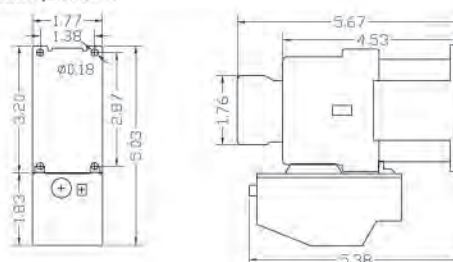

XLS11K

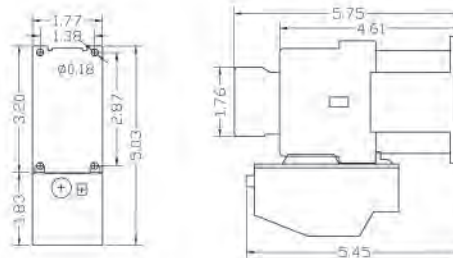

XLS15K, 18K

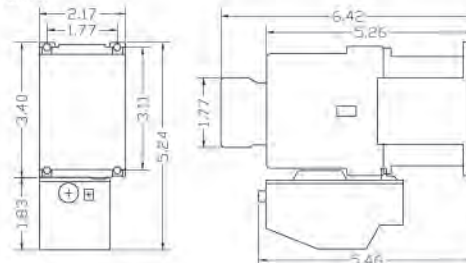

XLS22K, 30K, 37K

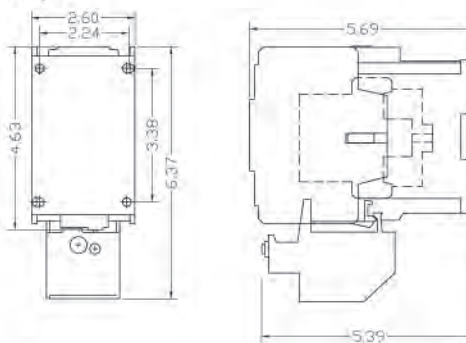

XLS45K, 55K

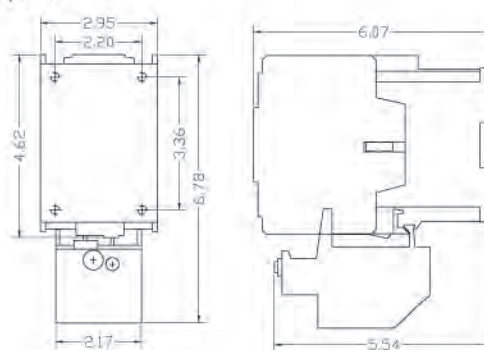



# XLS Starter Drawings

**XLS STARTERS**  
Dimension Drawings (in.)

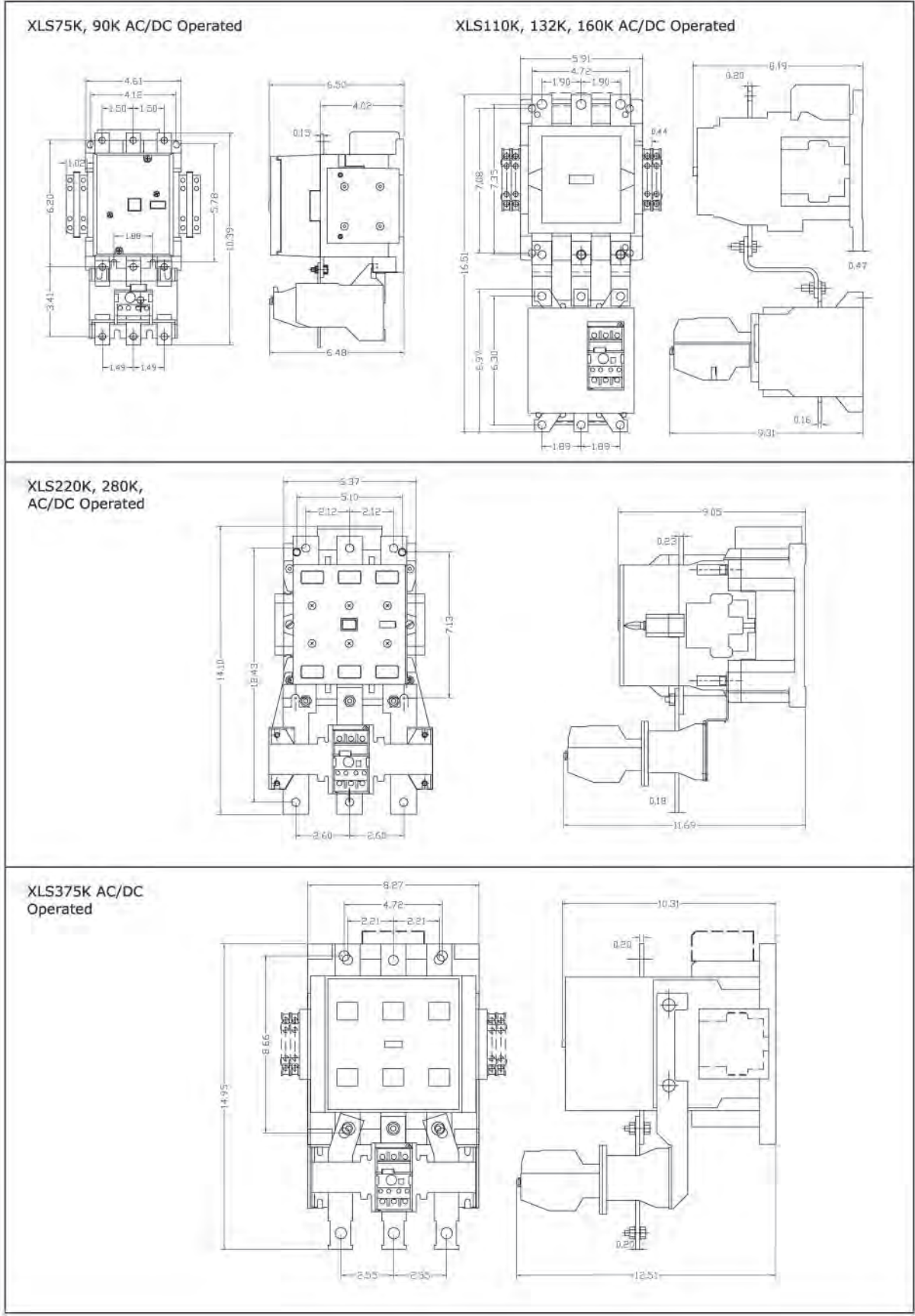



# RXLS Starter Drawings

## RXLS STARTERS Dimension Drawings (in.)

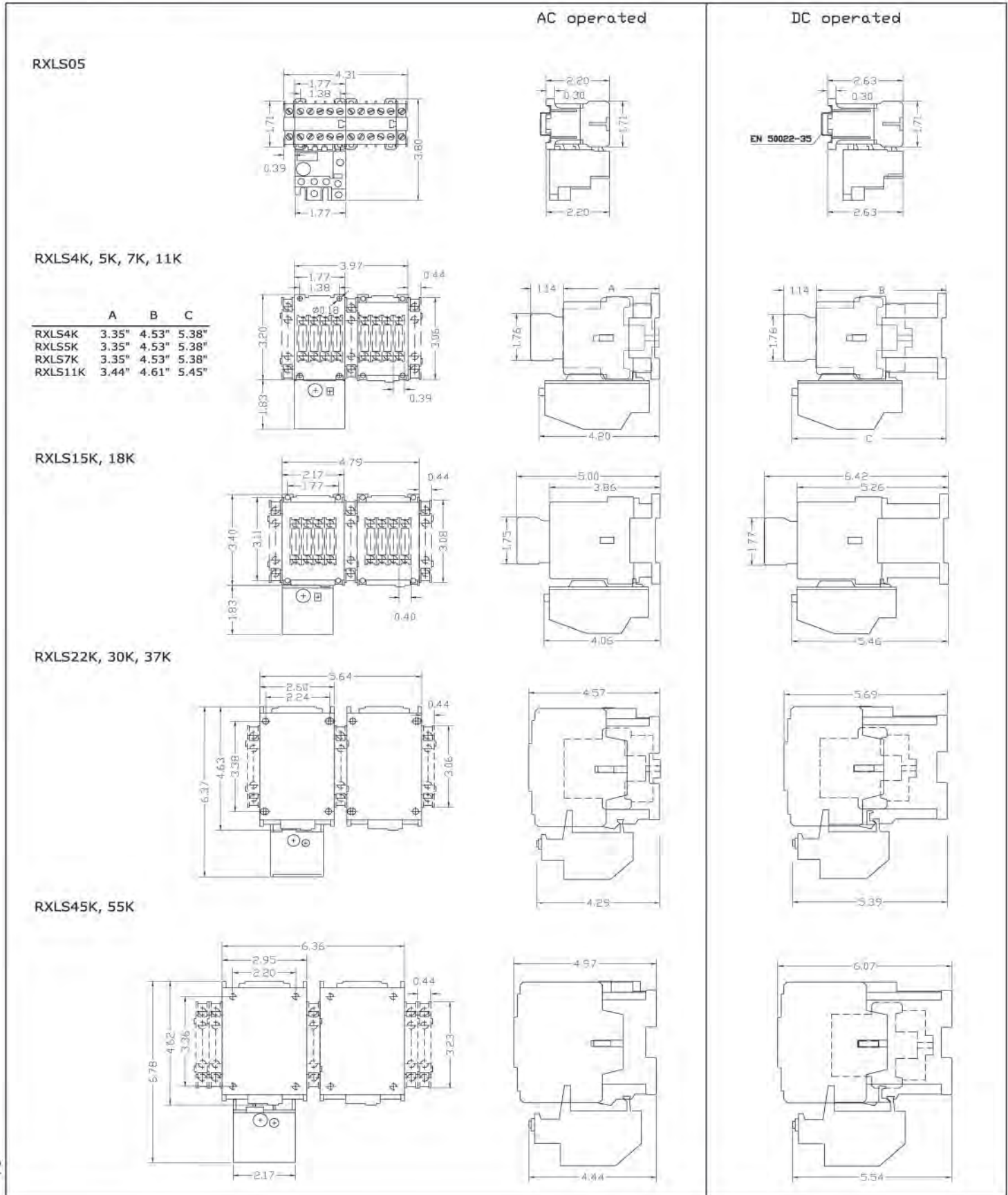



# RXLS Starter Drawings

## RXLS STARTERS Dimension Drawings (In.)

